

# 5.00mm

(0.196'') PITCH CONNECTOR

## Wire to Board Connectors

### Housing



YPH500-NN

### Material

I/NO	DESCRIPTION	MATERIAL
1	HOUSING	NYLON 66, UL94V-0

### Available Pin

PARTS NO.	A	B
YPH500-02	13.1	7.5
YPH500-03	18.1	12.5
YPH500-04	23.1	17.5
YPH500-05	28.1	22.5
YPH500-06	33.1	27.5

### Specification

ITEM	SPEC
Voltage Rating	AC/DC 250V
Current Rating	AC/DC 5A
Operating Temperature	-25°C~+85°C
Contact Resistance	30mΩ MAX
Withstanding Voltage	AC1000V/1min
Insulation Resistance	1000MΩ MIN
Applicable Wire	AWG #20~#26
Applicable P.C.B	-
Applicable FPC/FFC	-
Solder Height	-
Crimp Tensile Strength	-
UL FILE NO	-

◆ Applicable Terminal : YLT500

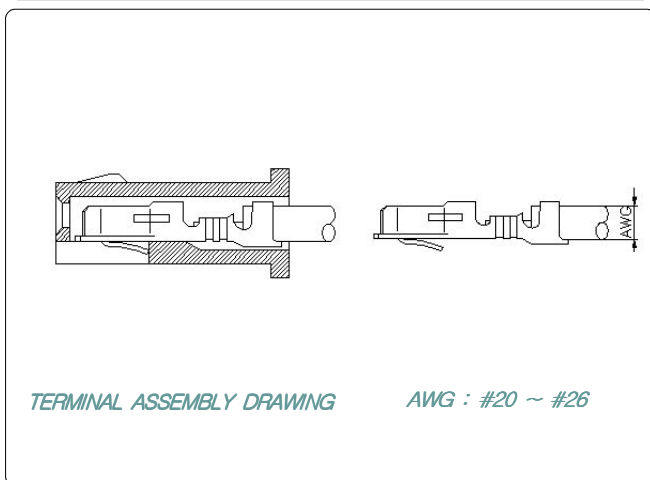
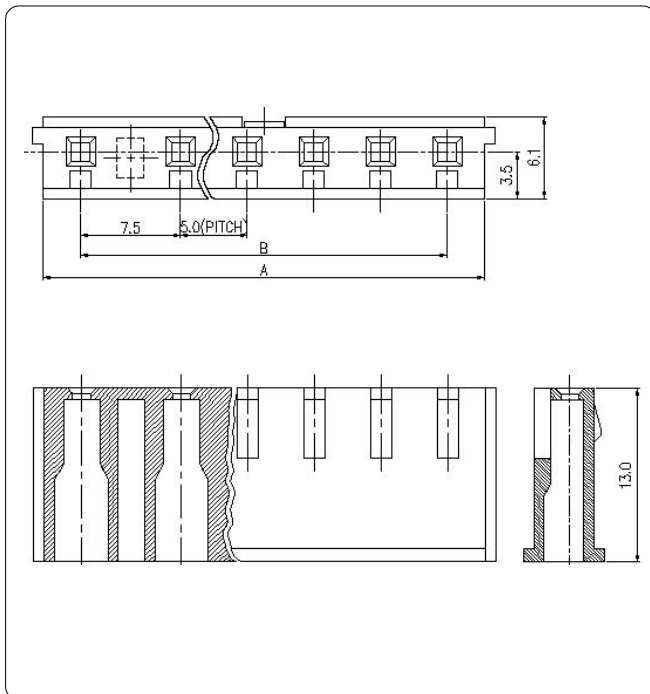

TERMINAL ASSEMBLY DRAWING

AWG : #20 ~ #26